

REPORT OF COMPLETED WORKS - SEACOAST FORTIFICATIONS.
(Gun and Mortar Batteries)

Recd with 66213 (S.D. Rosecrans) F17

COAST DEFENSES OF SAN DIEGO, CAL.
FORT ROSECRANS.

Form 1. Corrected to August 19, 1919.

X BATTERY JOHN WHITE.
No. of guns FOUR Caliber TWELVE INCH Carriage MORTAR

Battery commenced	November 8, 1915.	Sources of electric current	Two 25-kw. sets in battery central power plant and commercial power.
Battery completed	August 19, 1919.	Max. kw. required for lights	12.00
Date of transfer	August 19, 1919.	Max. kw. required for motors	None.
Material of construction	Concrete reinforced	Present condition of battery	Excellent.
Portland or Rosendale cement	Portland.	Rooms wet or dry	Dry.
Cost to date of transfer	\$144,200.	How ventilated	10" concrete vents
Connected to water supply	Yes.	Remarks-	
Connected to sewer	Yes.		
Type of latrine	Flushing.		
Type of data transmission	Mechanical and tele- phone.		
Trunnion elevation in battery	Pit A 149.70 Pit B 129.65		
Datum plane			

ARMAMENT.

Emplacement or mortar No.	Guns or Mortars				Carriages						
	Cal.	length	model	Serial No.	Manufacturer	mounted	Type	model	Serial No.	Manufacturer	Motor
Pit A (1 2)	12"	141.125	1890 M	3	B.I.F. Prov. RI	Dec. 31, 1917	Mortar	1896 M	76	R. Poole & Son	None
	12"	141.125	1890M	27	Bethlehem.	Dec. 31, 1917	Mortar	1896 M	83	R. Poole & Son	None
Pit B (1 2)	12"	141.125	1890M	9	B.I.F. Prov. RI	Dec. 31, 1917	Mortar	1896 M	56	R. Poole & Son	None
	12"	141.125	1890M	4	do	Dec. 31, 1917	Mortar	1896 M	87	R. Poole & Son	None

HOISTS.

Emplacement Number	Type	Delivery	Motor						Date of transfer	Remodeled for long points
			Serial No.	Maker	H.P.	Volts	RPM	Type of control		
1										
2										
3					None.					

LISTED FOR DISPOSAL Cof.S 400.93 (SAN DIEGO) CM 17, 540 11/3/42

REPORT OF COMPLETED WORKS - SEACOAST FORTIFICATIONS.
 BATTERY PLAN
 CORRECTED TO
 FORM 7.

COAST DEFENSES OF SAN DIEGO, CAL.
 FORT ROSEGRANS.
 BATTERY WHITE
 NO. OF GUNS FOUR. CALIBER TWELVE INCH. CARRIAGE

M:
 1896 ME

Scale = $\frac{1}{800}$

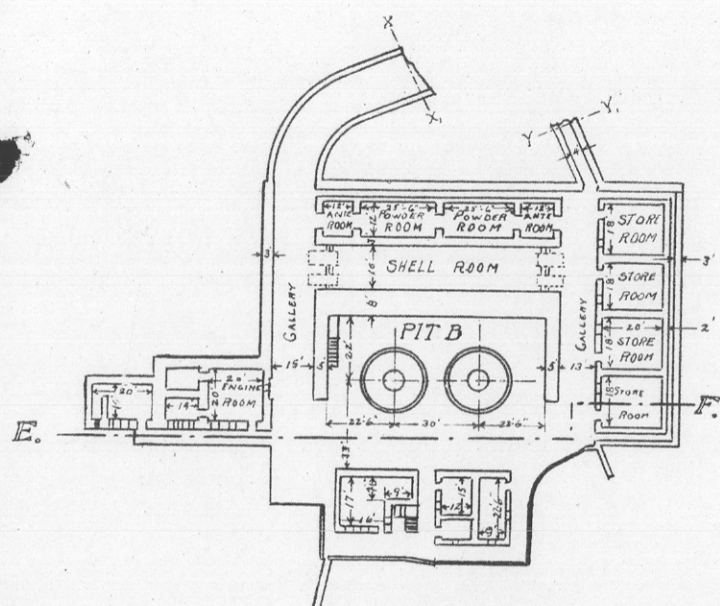
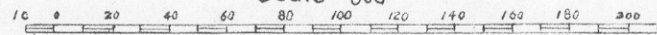

PLAN

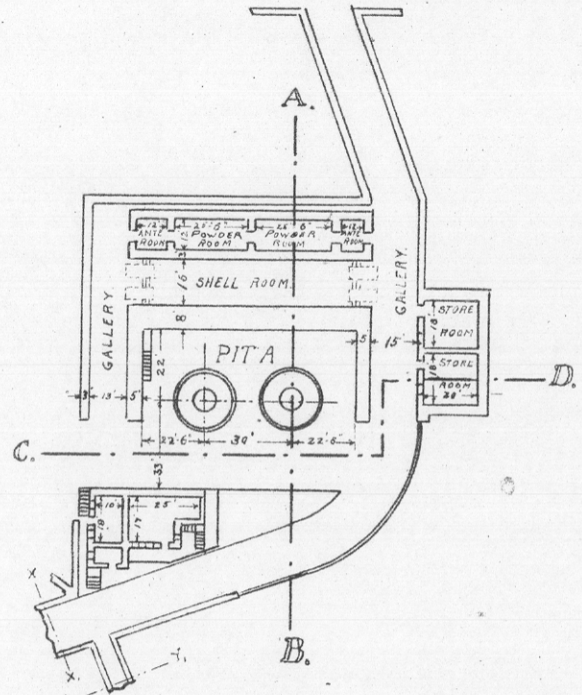

PLAN

SECTION A-B

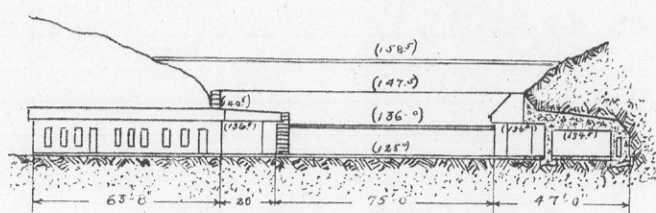
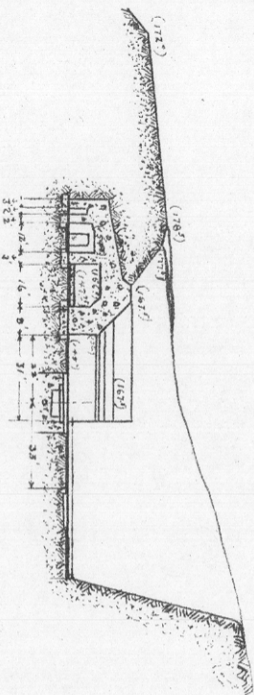

REAR ELEVATION E-F

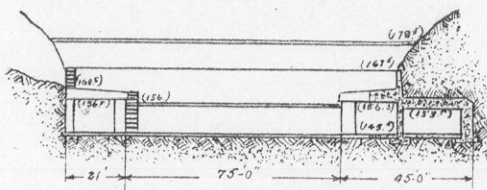

REAR ELEVATION C-D

CORPS OF ENGINEERS U.S. ARMY

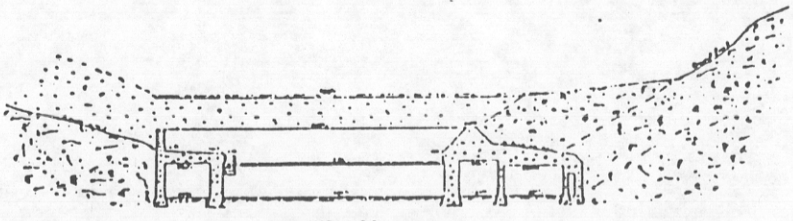
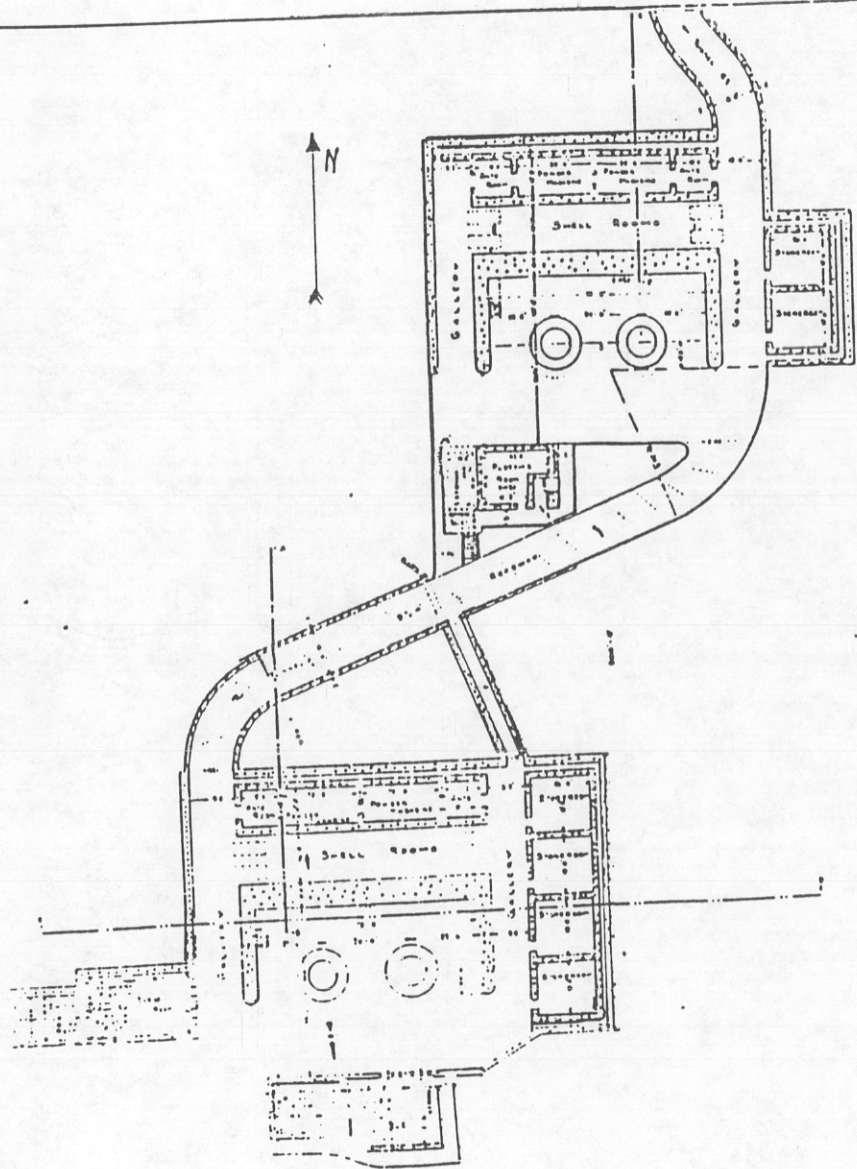

BATTERY JOHN WHITE SAN DIEGO

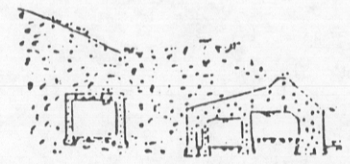
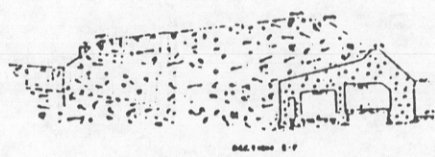

Office Chief of Engineers
U.S. Army
Nov 18, 1913
Submitted in the Secretary of War
approval recommendations
W. H. H. H.
Chief of Engineers

War Department
Nov 20, 1913
Approved
W. H. H. H.
Chief of Coast Artillery

War Department Dec 1, 1913
Approved
By order of the Secretary of War
J. C. G. G.
Major General of Staff

William Cross
Lee Scouts Co.
Dec 1, 1913
Approved in accordance with
Art 3, The Regulations
W. H. H. H.
Major, Corps of Engineers

William Cross
Lee Scouts Co.
Dec 1, 1913
Approved recommended for and in
the absence of Major Raymond
W. H. H. H.
Major, Corps of Engineers

MOORE BATTERY
POWER HOUSE CANYON
FORT ROSECRANS, CAL.

REPORT OF COMPLETED WORKS - SEACOAST FORTIFICATIONS.
 Electric Plants)

COAST DEFENSES OF SAN DIEGO, CAL.
 FORT ROSECRANS.
 POWER FOR BATTERY JOHN WHITE.

Form 5.

Corrected to August 19, 1919.

	Serial No.	Type	Size	Mfr.	Date of transfer	Cost	Con- dition	RPM	Belt or Direct Drive	Radiator for Engine No.	Fuel	Switchboard		
												Mate- rial	No. of Panels	
Boiler No.1														
No.2														
No.3														
Engine No.1	11012	GM 12	43/54	G.E.	Aug.19,1919		Good	600	Direct		Gasoline		See L75.1 (9th C.A.) 1	
No.2	11013	GM 12	43/54	G.E.	Aug.19,1919		Good	600	Direct			115 AC 3	60	No (suitable)
No.3												115 AC 3	60	No (suitable)
Generator														
No.1	1423844	A.T.I.	25-kw.	G.E.	Aug.19,1919		Good	600	Direct					
No.2	1423842	A.T.I.	25-kw.	G.E.	Aug.19,1919		Good	600	Direct					
No.3														
Radiator														
No.1	17089	F.F.54	B.9	G.E.	Aug.19,1919		Good	900	Direct	1				
No.2	17090	F.F.54	B.9	G.E.	Aug.19,1919		Good	900	Direct	2				
No.3														
Motor-generator														
No.1														
No.2														
No.3														
Switchboard														
Storage Battery												Marble	4	
Transformer														
No.1	L83820D	S	20KVA	Westing-	Aug.19,1919		Good							
No.2	L83820D	S	20KVA	house	Aug.19,1919		Good							
No.3	L83820D	S	20KVA	do	Aug.19,1919		Good							
Induction Motors														
No.1	1483576	KT 201	3 H.P.	G.E.	Aug.19,1919		Good	900	Direct					
No.2	1400207	KT 201	3 H.P.	G.E.	Aug.19,1919		Good	900	Direct					
No.3														

DISTRIBUTION OF KW. Lights 12.00 k.w. Zone Signals 1.32 k.w. Fire Control Switchboard Motor-Generator .93 k.w.

W/665 (San Diego) CU-6102

REPORT OF COMPLETED WORKS - SEACOAST FORTIFICATIONS
(Fire control or Torpedo Structures)

HARBOR DEFENSES OF SAN DIEGO, CALIFORNIA
FORT ROSECRANS
STRUCTURE: EXTENSION TO FIRE CONTROL
SWITCHBOARD ROOM

Form 2. Corrected to July 31, 1942

STRUCTURE:	:	:	:
Location	:	At Battery White	INSTRUMENTS AND EQUIPMENT:
Date of transfer	:	April 23, 1941	Type of observing inst.
Cost to that date	:	\$9002.10*	Type of plotting board
Time of construction	:		DATA TRANSMISSION
a) Roof	:	Reinforced concrete	Type of
(b) Remainder of bldg.	:	Reinforced concrete	Date of transfer
How concealed	:	Dug-out type constr.	Cost of data transmission equip.
How protected	:	R.O. burster slab and	
	:	7' manproof steel mesh	
	:	fence with 3 strands	
	:	barbed wire	
Height above concealment	:	13'-0"	
Height above protection	:	13'-0"	
Conspicuous at 200 yards	:		
ELECTRIC CURRENT:	:		
Source of	:	Battery White power	Remarks:
	:	and commercial power	*Cost includes gas proofing equip-
Kilowatts required	:	1 kw	ment and installation, after
Type of lighting fixtures	:	4-SF#0; 3-SF#1	transfer of structure.
How heated	:	Not heated	
WATER & SEWER:	:		
Connected to water mains	:	Yes	
Connected to sewer	:	Yes	
Type of latrine	:	Built-in	
Permanent or temporary inst'n	:	Permanent	
Present condition	:	Good	
REFERENCE:	:		
Reference of site	:	Adjoining Batt. White	
Reference of instrument axis	:	None	
Type and capacity of crane	:	None	
Max. dim. of reel handled.	:	None	

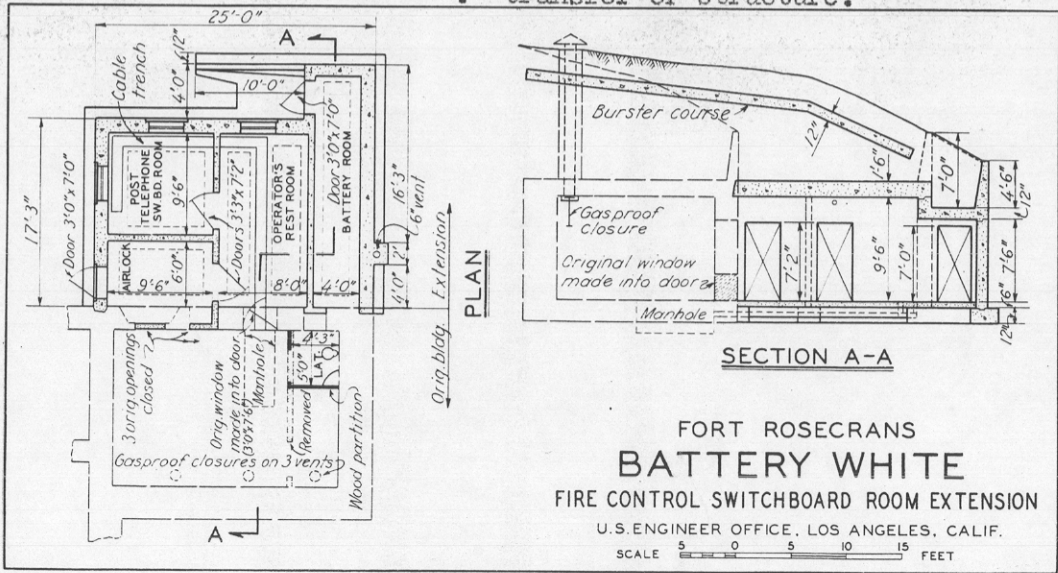

Prof. Card #146

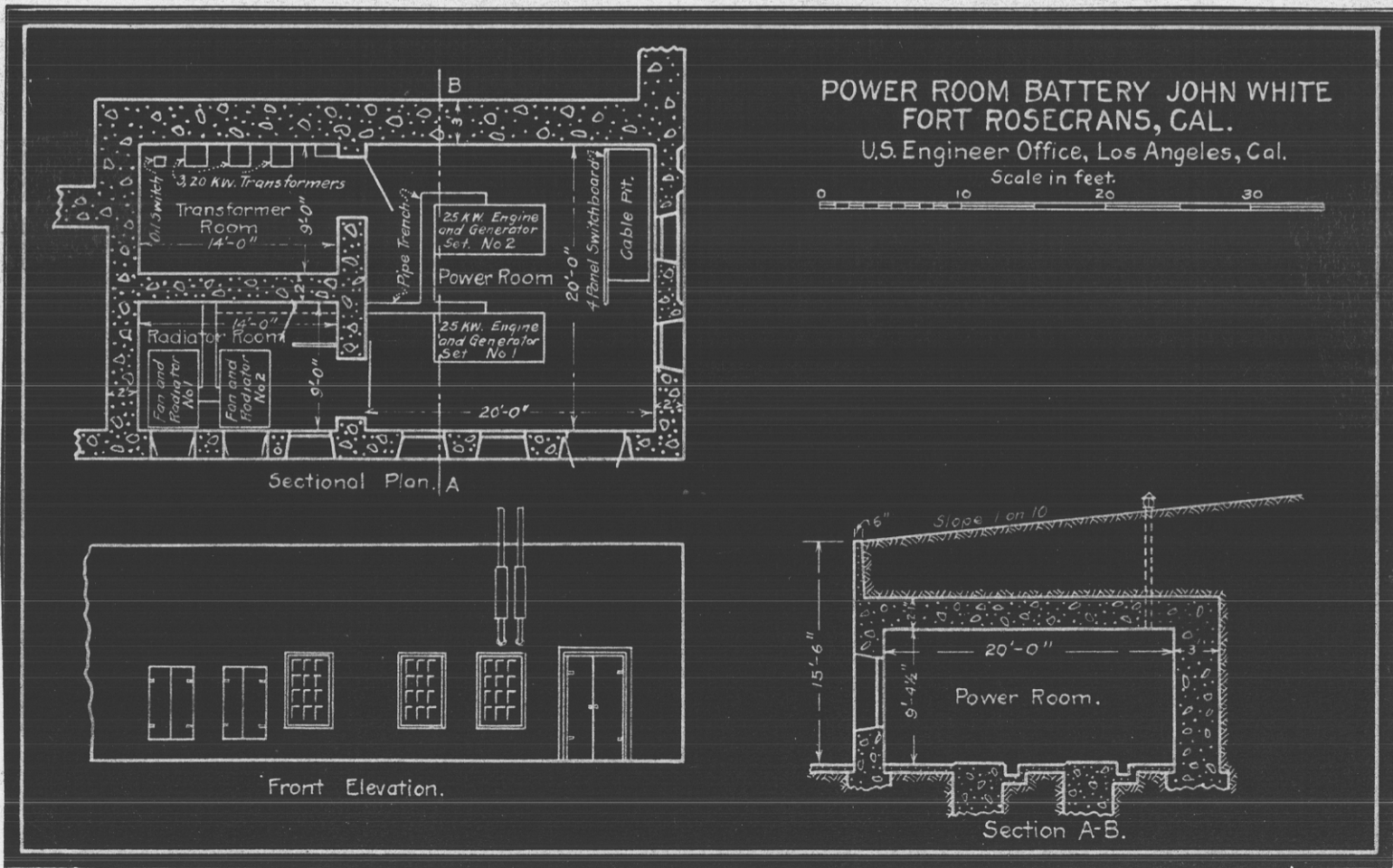

NOV 1915

REC'D WITH 660 (SAN FRANCISCO) CM 20788 11/27/42

REPORT OF COMPLETED WORKS - SEACOAST FORTIFICATIONS

HARBOR DEFENSES OF SAN DIEGO, CALIFORNIA
FORT ROSECRANS

Form 6.

Corrected to November 1942

STRUCTURE: FENCE - BATTERY JOHN WHITE

Battery White Fence-

Length - 1,420'. Overall height - 8'. Fabric - No. 6 gauge, 2" chain link mesh, 7' wide galvanized after fabrication. Barbed wire.- 4 point, galvanized, 3 strands on 45-degree receding arms. Posts and braces - round tubular steel. Gates- one 14' double-swing, one 10' single-swing, and one 4' single-swing.

Date completed - June 1938

Cost - 1,420' fencing and materials - - - \$1,369.40

Labor - - - - - 1,163.20

Total - - - - - \$2,532.60

