

**DEFENSE ENVIRONMENTAL RESTORATION PROGRAM  
FORMERLY USED DEFENSE SITES**

**INVENTORY PROJECT REPORT**

**GULL LAKE RECREATION CAMP  
MONO COUNTY, CALIFORNIA**

**SITE NO. J09CA081700**

**Prepared for:**

**SACRAMENTO DISTRICT, CORPS OF ENGINEERS  
1325 J Street  
Sacramento, CA 95814-2922**

**Prepared by:**

**DYNAMAC CORPORATION  
10419 Old Placerville Road, Suite 260  
Sacramento, CA 95827**

**September 1991**

**SITE SURVEY SUMMARY SHEET  
FOR  
DERP-FUDS SITE NO. J09CA081700  
Gull Lake Recreation Camp**

**SITE NAME(S):** Gull Lake Recreation Camp. The site was also known as Gull Lake Spike Camp.

**LOCATION:** The site is located in Mono County, California and is situated one half mile south of Gull Lake. See site map attached.

**SITE HISTORY:** In 1945, the Department of Defense acquired 5.00 permit acres from the Department of Agriculture, Forest Service (DAFS). The site was used by the U.S. Army as a recreational camp for Tonopah Army Air Field Personnel. According to the Project Ownership Map (Dept. of the Army), improvements included three barracks buildings, a mess hall, an office, a wash room, a toilet, and a water line. In 1947, the 5.00 permit acres were retransferred to DAFS. Records do not indicate if any restoration provisions were involved. In 1961, property which includes the subject site was leased by Mr. Bud Hayward and developed into a ski area (June Mountain Ski Area). The property is currently being leased from the DAFS by Mr. Dave McCoy and operated as June Mountain Ski Area.

**SITE VISIT:** A site visit was conducted on 29 May 1991 by Mr. Stephen Roe of Dynamac Corporation. The visual survey revealed little evidence of former DoD usage. The site is currently being used as the June Mountain Ski Area. Several above ground fuel tanks are currently being used by the June Mountain Ski operators. All of these tanks appear to be relatively new and not related to any previous DoD activity. No evidence of underground storage tanks was observed. A long time resident, Mr. Wilbur Tullock, stated that the DoD constructed improvements were removed at the time or shortly after DoD usage stopped in 1947. Mr. Tullock arrived in the area in 1949 and recalls the existence of cement structural supports, but no buildings. Significant grading has been performed since the area was developed as a ski slope. The only potential DoD improvement remaining was an abandoned 400' section of 4" diameter water piping in the southwest corner of the site. The piping does not constitute a structural, climbing, or engulfment hazard.

The California Hazardous Waste and Substances Sites list (CORTESE) was examined. The database includes input from the Department of Health Services, the State Water Resources Control Board, the nine Regional Water Quality Control Boards, and the California Waste Management Board. No records were found for this site.

**CATEGORY OF HAZARD:** NOFA.

**PROJECT DESCRIPTION: None proposed.**

**AVAILABLE STUDIES AND REPORTS: None identified.**

**PA POC: John Hoge, CESP-K-ED-M-HTW, 916-557-7421**

DEFENSE ENVIRONMENTAL RESTORATION PROGRAM  
FORMERLY USED DEFENSE SITES  
FINDINGS AND DETERMINATION OF ELIGIBILITY

GULL LAKE RECREATION CAMP  
MONO COUNTY, CALIFORNIA  
PROJECT NO. J09CA081700

FINDINGS OF FACT

1. On 15 March 1945, the U.S. Government acquired 5.00 permit acres from the Department of Agriculture, Forest Service (DAFS). Total acreage acquired for the subject site was 5.00.
2. The site was known as Gull Lake Spike Camp, CA. The site was situated in Mono County, 1/2 mile south of Lake Guard Station, and used by the U.S. Army as a recreational camp for Tonopah Army Air Field personnel. Improvements included three barracks buildings, a mess hall, office, wash room, and water line.
3. On 1 November 1947, 5.00 permit acres were re-transferred to DAFS.

DETERMINATION

Based on the foregoing Findings of Fact, the site has been determined to be formerly used by the DOD. It is therefore eligible for the Defense Environmental Restoration Program - Formerly Used Defense Sites established under 10 U.S.C. 2701 et seq.

23 Dec '91  
DATE

Mark W. Teter, COL, EN  
for ROGER F. YANKOUPE  
Brigadier General, U.S. Army  
Commanding

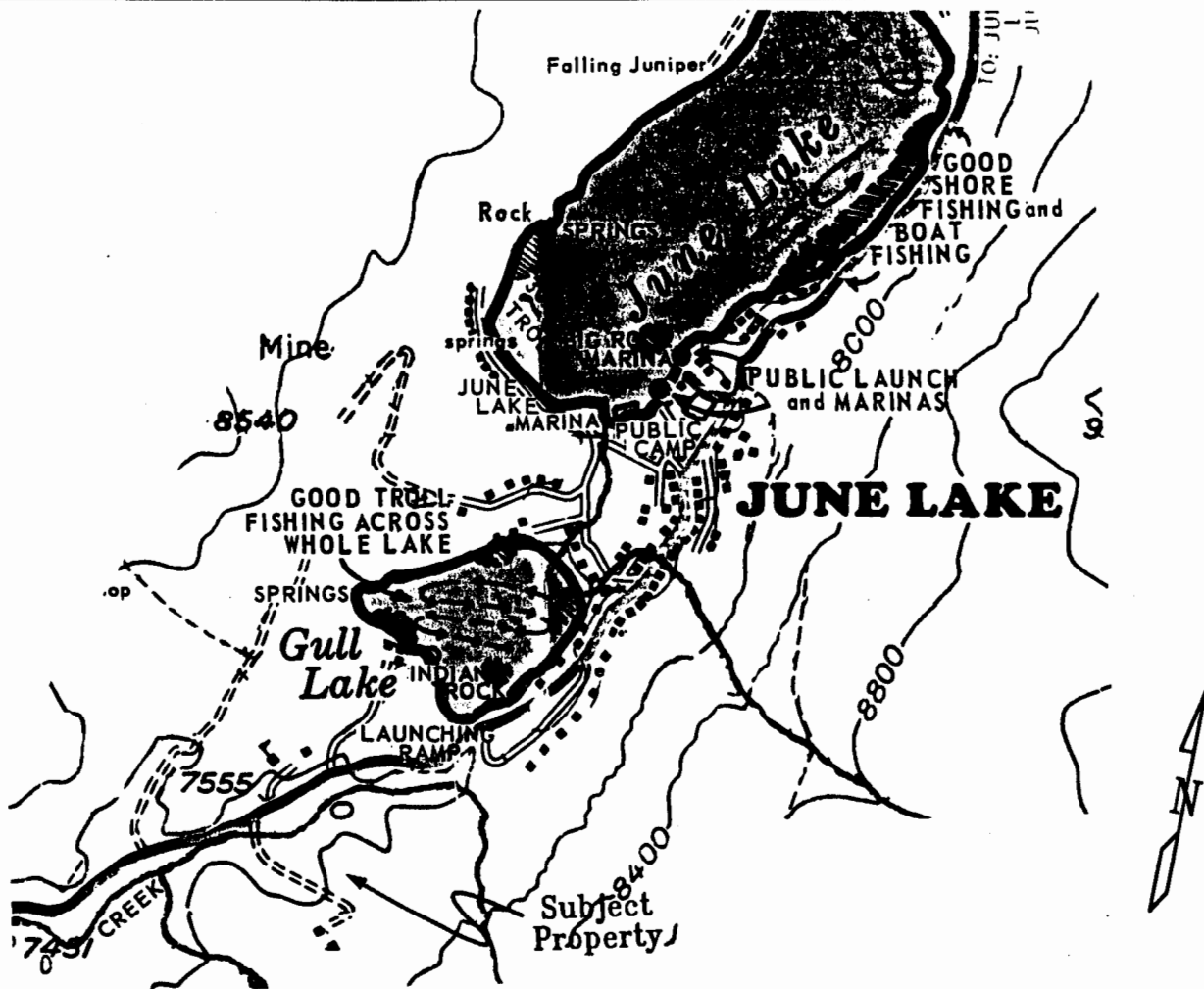

STATE INDEX

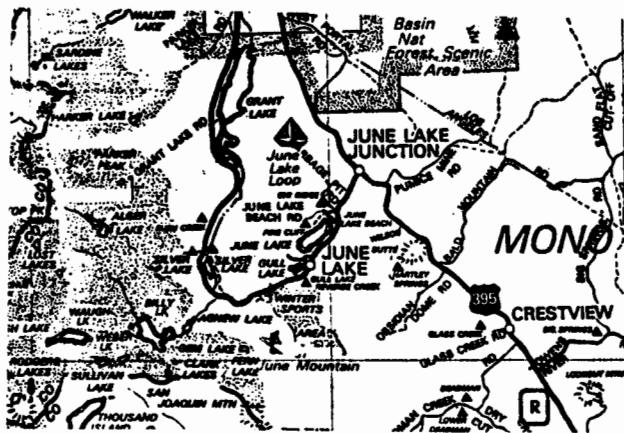

VICINITY MAP

**NOTES:**

1. Accurate delineation of the 5.00 permit acres was not available.
2. There was no visual evidence of hazards at the site.
3. NOT TO SCALE

**GULL LAKE  
RECREATION CAMP**

**DERP-FUDS  
INVENTORY PROJECT REPORT**

**SITE VISIT 29 MAY 1991**

**PHOTOGRAPH LOG**

**SUBJECT: Defense Environmental Restoration Program (DERP)  
Gull Lake Recreation Camp, California**

**SITE NO. JO9CA081700**

**PHOTO NO.                      TITLE**

1.     Site view southeast from northwest corner.
2.     Site view south from northeast corner.
3.     Possible cement building supports near the northeast corner of the site.
4.     Section of abandoned metal piping (4" diameter) southeast of parking area.
5.     Ridge above parking area view north.
6.     View north from ridge above parking area - showing day care center.



PHOTO 1



PHOTO 2



PHOTO 3



PHOTO 4





PHOTO 5



PHOTO 6



DEFENSE ENVIRONMENTAL RESTORATION PROGRAM - FORMERLY USED DEFENSE SITES

LIST OF ALL DATA FOR A SITE

Site Name: GULL LAKE REC CAMP

Site Number: J09CA0817

06/02/93

FFID: CA99799F575400

Geographical FOA : SPK City: GULL LAKE

County: MONO

State: CA Zip Code: -

Former Service: ARMY

NPL Listed(Y/N/P): N EPA Listed(Y/N): N Latitude: d m sN Longitude: d m sW

Current Site Name: JUNE MOUNTAIN SKI AREA

Current Owner(s): DOA

Current Owner Description:

Property is currently being leased from the DAFS by Mr. Dave McCoy and operated as June Mountain Ski Area.

POCS	Name	Office Symbol	Phone Number	Date Assigned
PROJ MGR:	N. STERLING	CESPK-ED-EB	(916)557-7227x	01/10/93
DISTRICT:	DON JONES	CESPK-ED-E	(916)557-7431x	01/10/93
DIVISION:	TONY MEI	CESPD-ED-GH	(415)705-1468x	01/10/93
HQ:	SARA ANGUS	CEMP-RF	(202)504-5223x	01/10/93
OTHER:			( ) - x	01/10/93

PRELIMINARY ASSESSMENT (PA) - INPR

	Schedule Start	Actual Start	Schedule Complete	Actual Complete
INITIAL:	04/08/91	04/08/91	12/23/91	12/23/91
AMEND:	--/--/--	--/--/--	--/--/--	--/--/--
AMEND:	--/--/--	--/--/--	--/--/--	--/--/--

Potential OEW: U Potential CSM: U INPR Status: C Underway Status:

Remarks:

nofa

FINDINGS AND DETERMINATIONS

Were hazards found (Y/N): N

Site Eligible/Ineligible/Categorical Exclusion (E/I/C): E

Categorical Exclusion:

Ineligible Findings:

DEFENSE ENVIRONMENTAL RESTORATION PROGRAM - FORMERLY USED DEFENSE SITES

LIST OF ALL DATA FOR A SITE

Site Name: GULL LAKE REC CAMP

Site Number: J09CA0817

06/02/93

---

Ineligible/Categorical Exclusion Remarks:

*Category	*Number	Project NOFA Y/N	Project Req	Approval Date	OEW RAC	Description
-----					0	
-----						