

Course	Bearing	Distance	Notations
2	S 67° 55' W	173.0 Feet	
3	N 0° 15' W	20.1 "	
4	N 39° 30' W	106.3 "	
5	N 29° 05' W	55.5 "	
6	N 15° 18' W	59.6 "	
7	N 65° 07' W	64.6 "	
8	N 50° 53' W	42.0 "	
9	N 50° 53' W	179.0 "	
10	N 53° 35' W	70.2 "	
11	N 47° 37' W	79.4 "	
12	N 43° 53' W	113.0 "	
13	N 63° 00' W	65.0 "	
14	N 52° 30' W	115.0 "	

NOTE: Above courses run northwesterly from SE corner of tract along a line 15 ft. northerly, meas. at rt angles, from center line of road (as located in 1903).

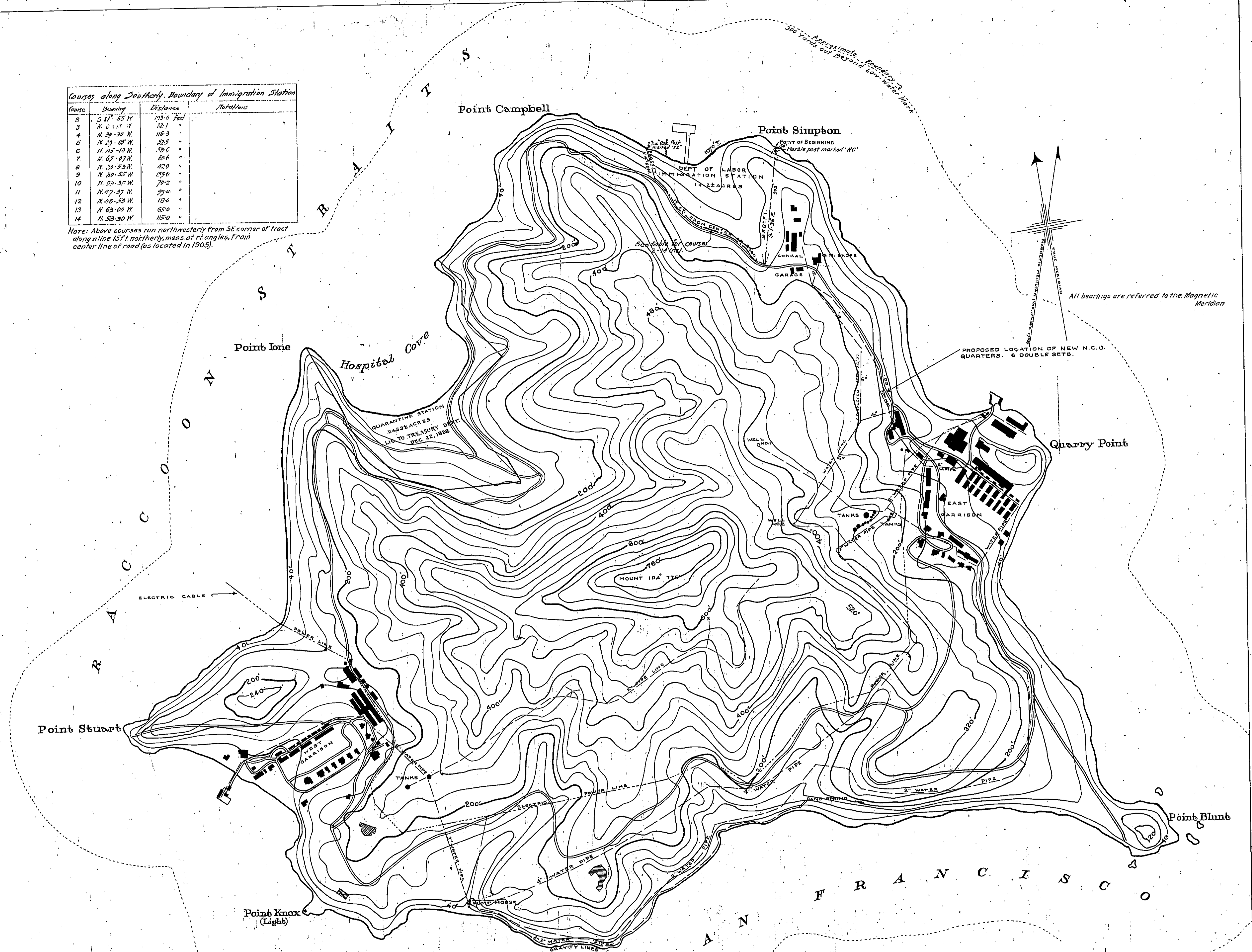

LEGEND

The military reservation of Fort McDowell is situated on Angel Island in San Francisco Bay about 7 miles northeast of the City of San Francisco, in Marin County, California. It was reserved for military purposes by Executive Orders dated Nov. 6, 1850 and Apr. 26, 1860. Jurisdiction ceded by State Legislature March 31, 1891. Exclusive jurisdiction ceded Mar. 2, 1897 (Cal. Stats. 1897, P. 5) title to submerged land extending from H.W. mark out to 300 yards beyond. L.W. mark around entire island ceded by State (Act approved Mar. 9, 1897 (Cal. Stats. 1897, P. 7)). The Sec. of War, July 2, 1905 and Apr. 6, 1909 transferred to the Dept. of Commerce and Labor two parcels of land aggregating about 142 acres for the purposes of an immigrant detention station. Revocable License dated Dec. 22, 1888 to Treasury to use about 10 acres for a quarantine station. Revocable license dated July 15, 1909 to the Spring Valley Water Co. to install and maintain two meters (One at Fort McDowell and the other at Recruit Depot). On Apr. 4, 1910 The Ass. Sec. of War approved the landing of Cable near Point Blunt and running overland to Immigration Station as requested by Sec. of Commerce and Labor. For Minor Licenses see book on "Military Reservations etc." prepared in the Office of the Judge Advocate General, U.S. Army. Permission to install an electric light and electric sirens fog signal at Points Blunt and Stuart together with right to place extra cross arm on existing poles and to construct a new pole line where necessary, has been granted to the Bureau of Lighthouses by Secretary of War Oct. 23, 1914. The reservation, exclusive of the Dept. of Commerce and Labor (now Dept. of Labor) Immigration Station, contains an area, above high-water mark, of 626 acres, more or less.

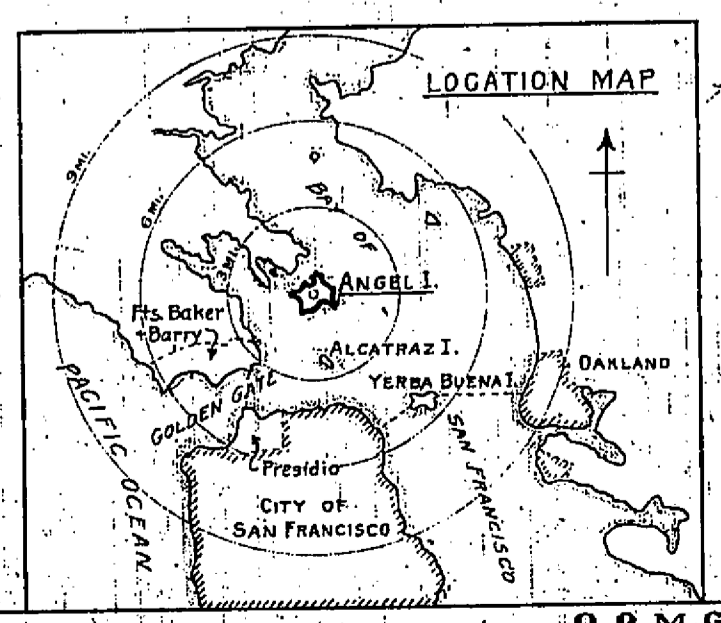

FORT McDOWELL ANGEL ISLAND, CALIFORNIA

RESERVATION MAP

Scale 1 Inch = 400 Feet

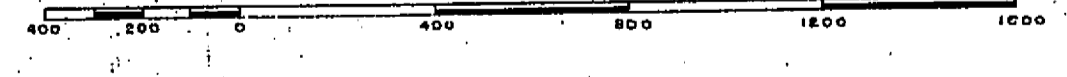

6473-109

DRAWN BY EDNA E. DAVIES

O. Q. M. G. APRIL, 1922.

FORT McDOWELL
Angel Island, Cal.